

PRODUCT SPECIFICATIONS



- Minimalistic design complements any aesthetic
- Flexible installation in many track and mono point systems
- 900 lumen output
- 90+ CRI
- White and black finishes
- Numerous lens, filter and snoot accessories
- Flicker-free TRIAC/ELV dimming

Track Light

LED: Tightly binned, high performing white Cree® LED.

LUMEN OUTPUT (POWER): 900 lm (16.1W).

CRI: 90+.

CCT: 2700K, 3000K, 3500K, 4000K.

BINNING: Color variation within 2-step MacAdam ellipse (SDCM).

OPTICS: Spot (15°), Narrow Flood (25°), Flood (35°).

DRIVER: Integral electronic driver for 120V operation only.

DIMMING: TRIAC/ELV for 120V only with flicker-free dimming down to 5% of total lumen output standard.

LIFETIME: 50,000 hours at 70% lumen maintenance.

PHOTOMETRIC TESTING: Tested in accordance to IESNA LM-79-2008.

LISTINGS: cULus Listed. ENERGY STAR® qualified. California Title 24 2013 compliant.

HOUSING: Die-cast aluminum with powder coating finish. Includes heatsink and driver compartment. Allows 350° horizontal and 330° vertical adjustment.

FINISH: White, black.

WARRANTY: 5 year limited warranty.

Installation

TRACK: Compatible with one or two circuit track systems.



Product Code:	Type:	
Project:	Contact:	Date:



PRODUCT SELECTION GUIDE

TRACK LIGHT (Product Code Example: **LT29927DSPW**)

PRODUCT CODE	LUMENS (W)	CRI	CCT	INSTALLATION	OPTIC	FINISH
LT2 Track Light	9 900 lm (16.1W)	9 90+ CRI	27 2700K 30 3000K 35 3500K 40 4000K	D DMF Lighting, Halo Compatible Track Adapter J Juno Compatible Track Adapter L Lightolier Compatible Track Adapter	SP Spot NF Narrow Flood FL Flood	W White B Black

ACCESSORIES

LSL Linear Spread Lens	HF Honeycomb Filter	YF Yellow Filter	SNW White Snoot
SPL Spread Lens	BF Blue Filter	GF Green Filter	SNB Black Snoot
FL Frosted Lens	RF Red Filter		

TRACK LIGHT DIMENSIONS

LT2
LED Track

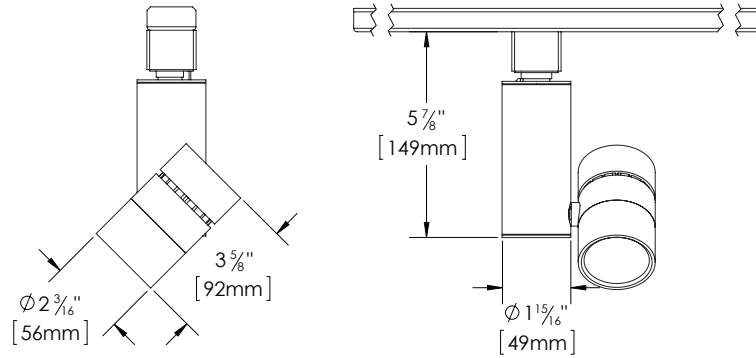

	LT2
Total Module Lumen Output (lm)	900
Total Rated Power (W)	16.1
Efficacy (lm/W)	54
Color Rendering Index	90+
CCT Options	2700K, 3000K, 3500K, 4000K
Optics	Spot (15°), Narrow Flood (25°), Flood (35°)
Binning	2-step SDCM
Lifetime (L70)	50,000 hours
Max Ambient Operating Temperature	40°C
Input Voltage (V)	120V
Input Current at 120V (Max)	0.143
Power Factor	>0.9
Total Harmonic Distortion	<20%
Dimming	100% - 5%

PHOTOMETRICS

Track Light: **LT29930DSPW** (LT2 Track Light, 900 lm, 90 CRI, 3000K, Spot)

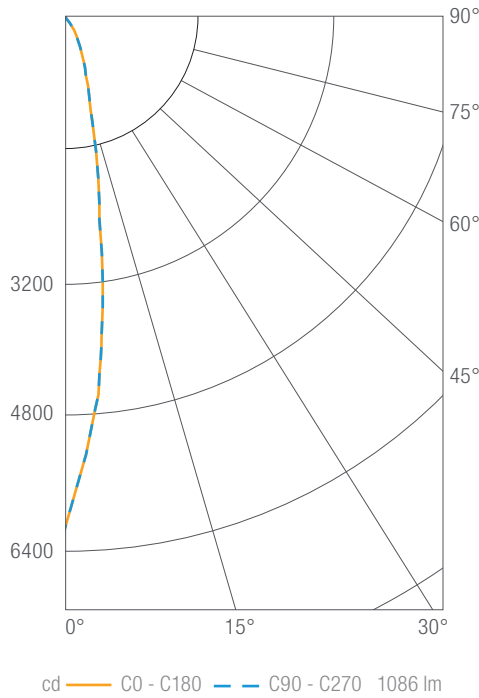

Luminous Intensity

Gamma	C 0°
0°	6137
5°	4562
10°	2358
15°	1175
20°	721
25°	449
30°	280
35°	140
40°	62
45°	29
50°	11
55°	6
60°	5
65°	2
70°	1
75°	1
80°	0
85°	0
90°	0

Values in candela

Zonal Lumen Summary

Zone	Lumens	Luminaire %
0-30	956	88
0-40	1052	97
0-60	1083	100
0-90	1086	100
0-180	1086	100

Illuminance Chart

Distance from LED	Foot Candles	Diameter
3.0'	682	0.9'
6.0'	170	1.8'
9.0'	76	2.6'
12.0'	43	3.5'

Beam Angle: 15°

Track Light: **LT29930DNFW** (LT2 Track Light, 900 lm, 90 CRI, 3000K, Narrow Flood)

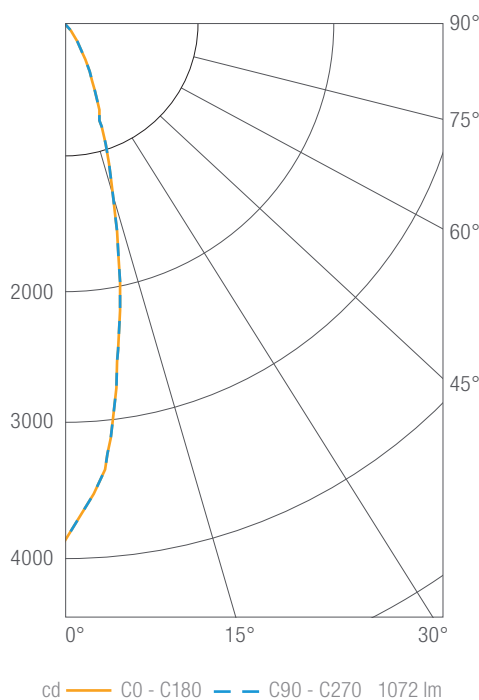

Luminous Intensity

Gamma	C 0°
0°	3884
5°	3382
10°	2345
15°	1399
20°	782
25°	499
30°	310
35°	157
40°	65
45°	31
50°	12
55°	6
60°	4
65°	2
70°	1
75°	1
80°	0
85°	0
90°	0

Values in candela

Zonal Lumen Summary

Zone	Lumens	Luminaire %
0-30	930	87
0-40	1036	97
0-60	1069	100
0-90	1072	100
0-180	1072	100

Illuminance Chart

Distance from LED	Foot Candles	Diameter
3.0'	432	1.3'
6.0'	108	2.6'
9.0'	48	3.9'
12.0'	27	5.2'

Beam Angle: 25°

PHOTOMETRICS

Track Light: **LT29930DFLW** (LT2 Track Light, 900 lm, 90 CRI, 3000K, Flood)

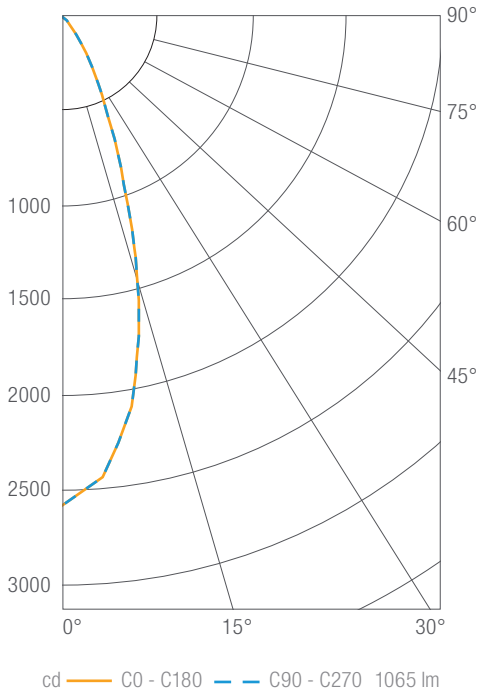

Luminous Intensity

Gamma	C 0°
0°	2569
5°	2431
10°	2088
15°	1554
20°	946
25°	545
30°	323
35°	166
40°	78
45°	39
50°	16
55°	7
60°	3
65°	2
70°	1
75°	1
80°	0
85°	0
90°	0

Values in candela

Zonal Lumen Summary

Zone	Lumens	Luminaire %
0-30	910	85
0-40	1022	96
0-60	1062	100
0-90	1065	100
0-180	1065	100

Illuminance Chart

Distance from LED	Foot Candles	Diameter
3.0'	285	1.9'
6.0'	71	3.7'
9.0'	32	5.6'
12.0'	18	7.4'

Beam Angle: 35°

CCT Scaling

LT29927 (2700K)	LT29930 (3000K)	LT29935 (3500K)	LT29940 (4000K)
0.93	1.00	1.00	1.07

DIMMER COMPATIBILITY

Recommended Phase-control Dimmers (Dims down to 5% nominal measured light output)

Brand	Series	Model Number	Max Load
Cooper	Decorator	DLC03P	6
	Decorator	DAL06P	5
Legrand	Adorne	ADTP703TU	8
Lutron	CL Series	DVCL-153	2
	CL Series	DVCL-253	4
	Maestro Wireless	MRF2-6ND	5
	Radio RA	RRD-6NA	5
	Grafik Sys / Homeworks	RPM-4A	5
	Grafik Sys / Homeworks	RPM-4U	7
	Grafik Eye 3000	QSGR-3P	14
Watt Stopper	Dimming Sensor	PW-100D	15

DIMMER COMPATIBILITY

Compatible Phase-control Dimmers¹ (Dims down to 20% nominal measured light output)

Brand	Series	Model Number	Max Load
Cooper	Aspire	9573	5
Leviton	IllumaTech Slide	IPE04	5
	IllumaTech Slide	IPE06	2
	SureSlide	6621	2
	SureSlide	6631, 6674	5
	Vizia	VPE04	7
	Vizia	VPE06	10
Lightolier	Sunrise	ZP260QEW	4
Lutron	Caseta	PD-6WCL	5
	Diva	DV-600	5
	Diva ELV	DVELV-300	5
	Maestro	MA-600	5
	Maestro CL	MACL-153M, MSCL-OP153M	5
	Maestro ELV	MAELV-600	7
	Radio RA	RRD-6CL	5
	Skylark	S-600P	2
	Skylark	S-1000	4
	Skylark Contour	CT-103P	4
	Skylark ELV	SELV-300	5
Philips	Sunrise	SR400RPC120	5
Watt Stopper	Digital Light Management	LMRC-221	142

¹ Dimmer compatibility reflects performance compatibility only. Please reference your local codes for application.

TRACK ACCESSORIES

All accessories are single circuit, 120V and available in white (W) or black (B)

LE1W, LE1B
Live End Connector

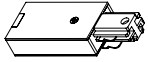

CLEW, CLEB
Conduit Fitting Live End

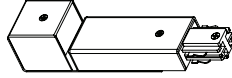

LECW, LECB
Live End with Canopy

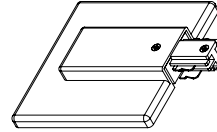

TCW, TCB
Track Connector

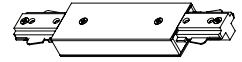

LCW, LCB
L Connector

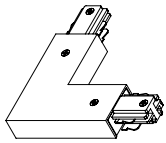

CPCW, CPCB
Cord and Outlet
Plug Connector

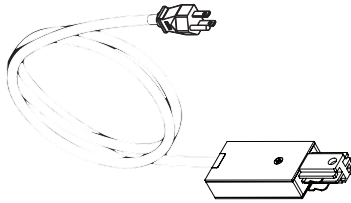

TRCW, TRCB
Mini Track
Connector

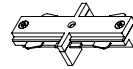

TBJW, TBJB
T-Bar Ceiling
Junction Box

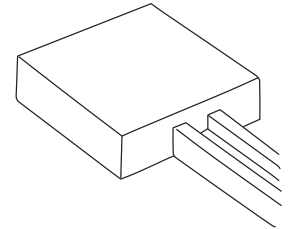

FCW, FCB
Floating Canopy

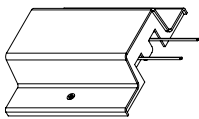

MPW, MPB
Monopoint Adapter

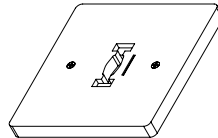

TAC, TAC9
T-Bar Attachment
Clip



**EX18W, EX18B, EX24W, EX24B,
EX36W, EX36B, EX48W, EX48B**
Extension Rod (18", 24", 36", 48")

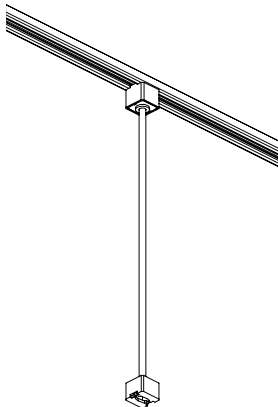

TCL1-EF-xxx-W, TCL1-EF-xxx-B
End Feed Current Limiters

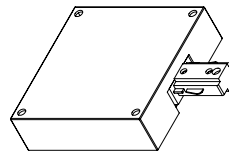

**DT2W, DT2B,
DT4W, DT4B,
DT6W, DT6B,
DT8W, DT8B,
DT12W, DT12B**
Circuit Track
(2', 4', 6', 8', 12')

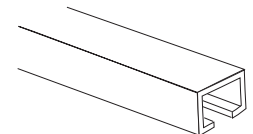

XXX	Circuit Breaker
120	120W (1amp @ 120V)
300	300W (2.5amp @ 120V)
600	600W (5amp @ 120V)
960	960W (8amp @120V)
1200	1200W (10amp @ 120V)